

GENERAL NOTES:

1. CUSTOM HURRICANE PRODUCTS EZ-SCREENS MAY HAVE BEEN DESIGNED AND TESTED IN ACCORDANCE WITH FLORIDA BUILDING CODE CHAPTER 16 AND TAS 201, 202, AND 203 FOR LARGE MISSILE IMPACT, AND MEETS THE NON-POROUS REQUIREMENTS FOR OUTSIDE THE HIGH VELOCITY HURRICANE ZONES

2. NO ALLOWABLE STRESS INCREASE HAS BEEN USED IN THE DESIGN OF THE EZ-SCREENS.

3. ADEQUACY OF EXISTING STRUCTURE SHALL BE DETERMINED BY OTHERS.

4. UNIT HEIGHT (DISTANCE BETWEEN SUPPORTED SIDES) SHOWN IS MAXIMUM ALLOWABLE WITHOUT SITE-SPECIFIC ENGINEERING. LENGTHS UNLIMITED.

5. SCREEN FABRIC SHALL BE MIN. 20 MIL. POLYPROPYLENE, WOVEN USING 138 POLYESTER THREAD, TAVARA THREAD BY GORE WITH MIN. TENSILE BREAKING TEST STRENGTH OF 15 LBS.

6. GLAZING SEPARATION IS NOT REQUIRED, OUTSIDE HVHZ EXCEPT FOR WIND ZONE 4 AND ALL WIND ZONES FOR ESSENTIAL FACILITIES. SEE DETECTION AND SCREEN SEPARATION REQUIREMENTS FOR THESE ZONES ON SHEET 1. SCREEN FABRIC SHALL HAVE POROSITY <= 10%.

7. MOUNTING BRACKET SHALL BE FASTENED TO SUBSTRATE ACCORDING TO EZ-SCREEN BRACKET TABLE AND FASTENER MANUFACTURER DIRECTIONS.

8. MAX. ALLOWABLE DESIGN PRESSURES: +/- 60 PSF

9. SEE SHEET 3 FOR FABRIC SPECIFICATIONS.

10. THE PRODUCT SHALL BE LABELED IN ACCORDANCE WITH IBC - 1715.8

TYP. EXTERIOR ELEVATION

SCALE: N.T.S.

1

NOTE:
 -FASTENING OF SCREEN SHALL BE GROMMETS, STRAP & BUCKLE, STRAP & BRACKET, OR ANY COMBINATION. ONLY ONE TYPE OF CONNECTION IS PERMITTED PER SIDE.
 -CONNECTION WRAPS OF SUPPORT POST ARE PERMITTED.
 -ONLY BUCKLES CAN BE PLACED ON OPPOSITE SIDE ON ONE SIDE OF SCREEN TO ALLOW FOR EGRESS OF OPENING

GLASS SEPARATION + SCREEN DETECTION TABLE W/O STORM BARS

W (CLEAR SPAN)	21'2"	19'7"	16'8"	14'4"	12'0"	10'2"	OR LESS
SEPARATION DISTANCES BETWEEN PROTECTED GLAZING AND SCREEN AT ZONE 4 AND ESSENTIAL BUILDINGS	33'1"	31'	28'	25'	22'	15'	

SCREEN DETECTION TABLE W/ STORM BARS

W OR CLEAR SPAN	9'6"	8'4"	7'2"	6'0"	4'8"	3'6"	3'0"
TOTAL DETECTION OF SCREEN AND STORM BAR SYSTEM	1'4"	1'4"	1'4"	1'4"	1'4"	1'2"	1'
SEPARATION DISTANCES BETWEEN PROTECTED GLAZING AND SCREEN AT ZONE 4 AND ESSENTIAL BUILDINGS	5'1"	5'1"	5'1"	5'1"	5'1"	5'1"	5'1"

*TOTAL DETECTION OF THE SYSTEM FOR POSITIVE PRESSURES. GLASS SEPARATION OF 1' IS REQUIRED.

PRODUCT LABEL

THIS PRODUCT SHALL BE INSTALLED AND USED ONLY AS INTENDED PER THE INSTALLATION INSTRUCTIONS. THIS PRODUCT DOES NOT MEET ASTM D1929, ASTM E84, ASTM D2893, ASTM D535, AAMA 1600, OR ASTM G15, ASTM D2526, ASTM D256 AND SHALL NOT BE PERMANENTLY INSTALLED.

DO NOT REMOVE THIS LABEL

LABEL SHALL BE INSTALLED ON SCREEN FABRIC

NOTE: GROMMETS SHALL NOT BE USED IN TRAP MOUNT CONFIGURATIONS LOADS ARE PER FASTENER

W	SPACING	SHEAR REACTION
17'-8"	7" O.C.	309 #
16'-0"	7" O.C.	280 #
14'-0"	8" O.C.	300 #
12'-0"	10" O.C.	300 #
10'-0"	12" O.C.	300 #
8'-6"	14" O.C.	298 #
OR <		

LOADS ON STRUCTURE

W	TENSION	SHEAR
17'-8"	1097 #/FT	531 #/FT
16'-0"	993 #/FT	480 #/FT
14'-0"	889 #/FT	420 #/FT
12'-0"	745 #/FT	360 #/FT
10'-0"	621 #/FT	300 #/FT
8'-6"	528 #/FT	255 #/FT
OR <		

NOTE: FOR LOADS ON STRUCTURES FOR WIND PRESSURES LESS THAN 60 PSF, VALUES IN THE TABLE MAY BE OBTAINED BY THE FOLLOWING FORMULA:
 VALUE FROM TABLE X PRESSURE DESIRED / 60 PSF

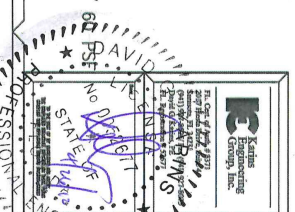

<p>Sheet Description:</p> <p>'EZ-SCREEN MAX' POLYPROPYLENE SCREEN HURRICANE SHUTTER INSTALLATION INSTRUCTIONS</p>	<p>Project Name:</p> <p>CUSTOM HURRICANE PRODUCTS</p> <p>2024 58TH AVE CIR E BRADENTON FL 34203 WWW.CUSTOMHURRICANERODUCTS.COM</p>
<p>Code:</p> <p>DKC</p> <p>Spec:</p> <p>06CS-0397</p> <p>Varies:</p> <p>9/09/2010</p>	<p>Scale:</p> <p>N.T.S.</p> <p>1</p>

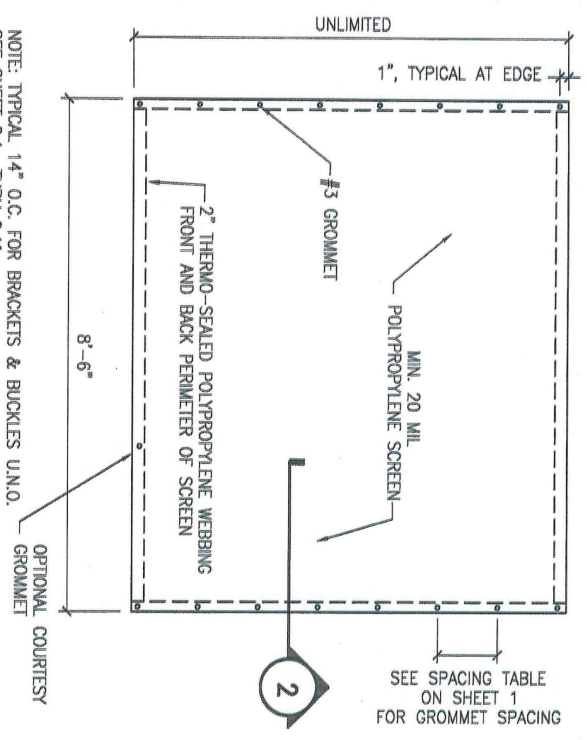

NOTE: TYPICAL 14" O.C. FOR BRACKETS & BUCKLES U.N.O. SEE SHEET 2.10 THRU 2.17

TYP. EXTERIOR ELEVATION

SCALE: N.T.S.

GENERAL NOTES:

1. CUSTOM HURRICANE PRODUCTS EZ-SCREENS MAY HAVE BEEN DESIGNED AND TESTED IN ACCORDANCE WITH FLORIDA BUILDING CODE CHAPTER 16 AND TAS 201, 202, AND 203 FOR LARGE MISSILE IMPACT, AND MEETS THE NON-POROUS REQUIREMENTS FOR OUTSIDE THE HIGH VELOCITY HURRICANE ZONES
2. NO ALLOWABLE STRESS INCREASE HAS BEEN USED IN THE DESIGN OF THE EZ-SCREENS.
3. ADEQUACY OF EXISTING STRUCTURE SHALL BE DETERMINED BY OTHERS.
4. UNIT HEIGHT (DISTANCE BETWEEN SUPPORTED SIDES) SHOWN IS MAXIMUM ALLOWABLE WITHOUT SITE-SPECIFIC ENGINEERING. LENGTH IS UNLIMITED.
5. SCREEN FABRIC SHALL BE MIN. 20-MIL. POLYPROPYLENE, WOVEN USING 138 POLYESTER THREAD, TAWARA THREAD BY GORE WITH MIN. TENSILE BREAKING TEST STRENGTH OF 15 LBS.
6. WHERE GLAZING SEPARATION IS NOT REQUIRED OUTSIDE HVHZ, EXCEPT FOR WIND ZONE 4 AND ALL WIND ZONES FOR ESSENTIAL FACILITIES, SEE DETECTION AND SCREEN SEPARATION REQUIREMENTS FOR THESE ZONES ON SHEET 1. SCREEN FABRIC SHALL HAVE POROSITY <= 10%.
7. MOUNTING BRACKET SHALL BE FASTENED TO SUBSTRATE ACCORDING TO 'EZ-SCREEN' BRACKET TABLE AND FASTENER MANUFACTURER DIRECTIONS.
8. **MAX. ALLOWABLE DESIGN PRESSURES: +/- 60 PSF**
9. SEE SHEET 3 FOR FABRIC SPECIFICATIONS.
10. THE PRODUCT SHALL BE LABELED IN ACCORDANCE WITH FBC - 1715.8

MOUNTING SECTION

SCALE: 3"=1'-0"

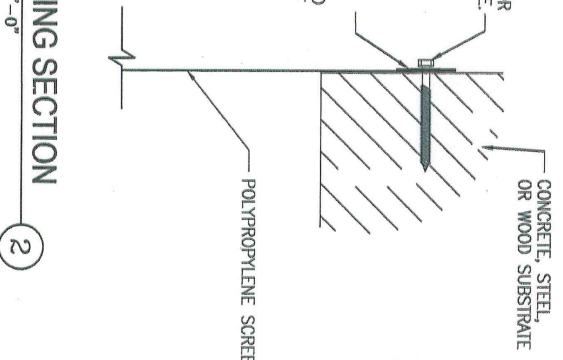

MOUNTING SECTION

SCALE: 3"=1'-0"

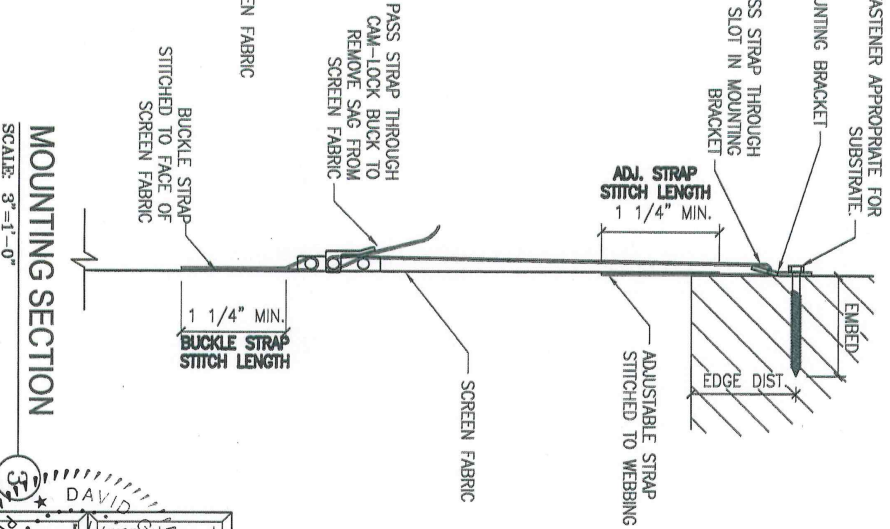

PRODUCT LABEL

THIS PRODUCT SHALL BE INSTALLED AND USED ONLY AS INTENDED PER THE INSTALLATION INSTRUCTIONS. THIS PRODUCT DOES NOT MEET ASTM D1929, ASTM E94, ASTM D2943, ASTM D635, AAMA 1600, OR ASTM G15, ASTM D2526, ASTM D256 AND SHALL NOT BE PERMANENTLY INSTALLED. **DO NOT REMOVE THIS LABEL**

LABEL SHALL BE INSTALLED ON SCREEN FABRIC

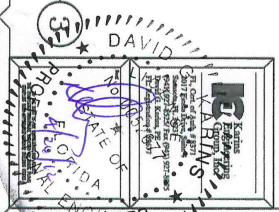

Project Name: CUSTOM HURRICANE PRODUCTS 2024 58TH AVE CIR E BRADENTON FL 34203 WWW.CUSTOMHURRICANERODUCTS.COM	Sheet Description: 'EZ-SCREEN MAX' POLYPROPYLENE SCREEN HURRICANE SHUTTER INSTALLATION INSTRUCTIONS	Date: 9/09/2010 Scale: 3"=1'-0" Drawing No: 1.2
--	--	--

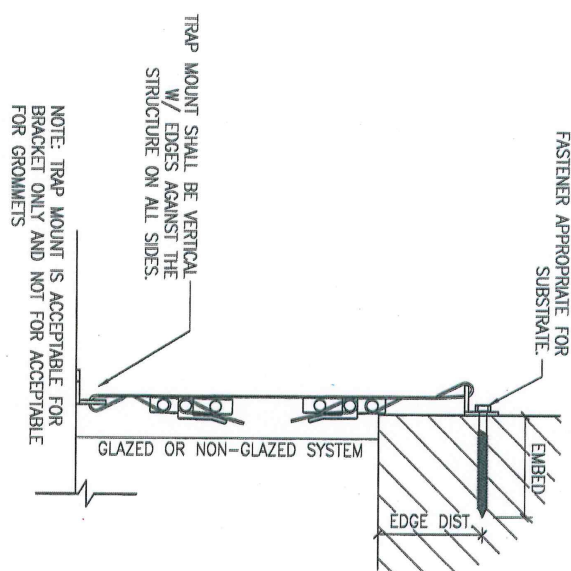

TRAP MOUNT
SCALE: 3"=1'-0"
2

GENERAL NOTES:

1. CUSTOM HURRICANE PRODUCTS EZ-SCREENS MAY HAVE BEEN DESIGNED AND TESTED IN ACCORDANCE WITH FLORIDA BUILDING CODE CHAPTER 16 AND TAS 201, 202, AND 203 FOR LARGE MISSILE IMPACT, AND MEETS THE NON-POROUS REQUIREMENTS FOR OUTSIDE THE HIGH VELOCITY HURRICANE ZONES
2. NO ALLOWABLE STRESS INCREASE HAS BEEN USED IN THE DESIGN OF THE EZ-SCREENS.
3. ADEQUACY OF EXISTING STRUCTURE SHALL BE DETERMINED BY OTHERS.
4. UNIT HEIGHT (DISTANCE BETWEEN SUPPORTED SIDES) SHOWN IS MAXIMUM ALLOWABLE WITHOUT SITE-SPECIFIC ENGINEERING. LENGTH IS UNLIMITED.
5. SCREEN FABRIC SHALL BE MIN. 20 MIL. PLOT/PROPYLENE, WOVEN USING 138 POLYESTER THREAD, TANARA THREAD BY GORE WITH MIN. TENSILE BREAKING TEST STRENGTH OF 15 LBS.
6. WHERE GLAZING SEPARATION IS NOT REQUIRED OUTSIDE HVHZ EXCEPT FOR WIND ZONE 4 AND ALL WIND ZONES FOR ESSENTIAL FACILITIES, SEE DEFLECTION AND SCREEN SEPARATION REQUIREMENTS FOR THESE ZONES ON SHEET 1. SCREEN FABRIC SHALL HAVE POROSITY <= 10%.
7. MOUNTING BRACKET SHALL BE FASTENED TO SUBSTRATE ACCORDING TO EZ-SCREEN BRACKET TABLE AND FASTENER MANUFACTURER DIRECTIONS.
8. **MAX. ALLOWABLE DESIGN PRESSURES: +/- 60 PSF**
9. SEE SHEET 3 FOR FABRIC SPECIFICATIONS.
10. THE PRODUCT SHALL BE LABELED IN ACCORDANCE WITH FBC - 1715.8

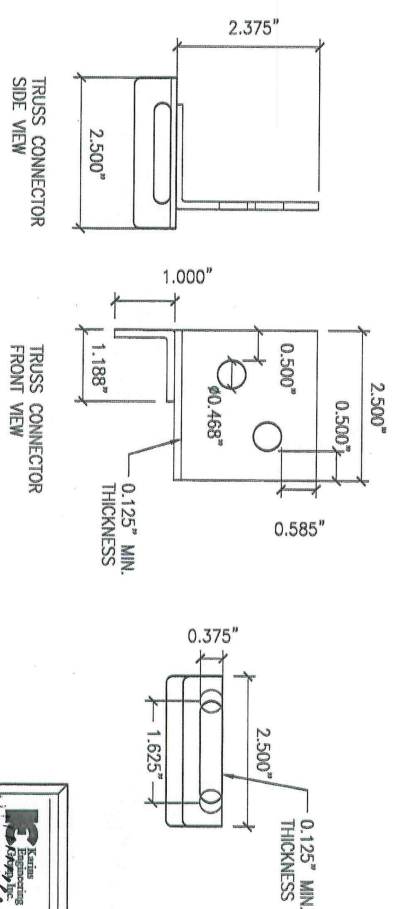
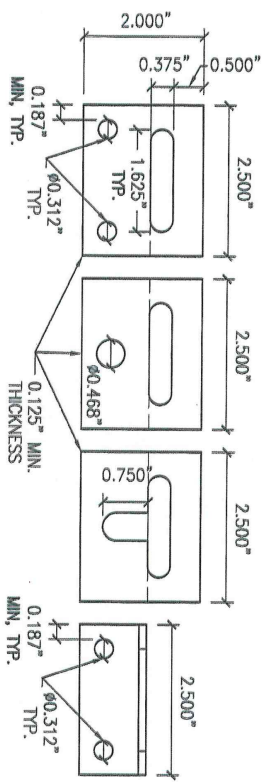

MOUNTING SECTION
SCALE: 3"=1'-0"
1

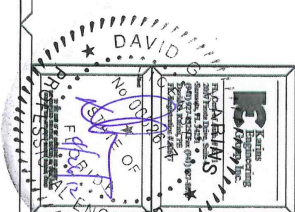

1.3	Project Name: CUSTOM HURRICANE PRODUCTS 2024 58TH AVE CIR E BRADENTON FL 34203 WWW.CUSTOMHURRICANERODUCTS.COM	Sheet Description: 'EZ-SCREEN MAX' POLYPROPYLENE SCREEN HURRICANE SHUTTER INSTALLATION INSTRUCTIONS	DSK 06CS-0397 VARIES 9/09/2010
-----	--	--	---

GENERAL NOTES:

1. CUSTOM HURRICANE PRODUCTS EZ-SCREENS MAX HAS BEEN DESIGNED AND TESTED IN ACCORDANCE WITH FLORIDA BUILDING CODE CHAPTER 16 AND TKS 201, 202, AND 203 FOR LARGE MISSILE IMPACT, AND MEETS THE NON-POROUS REQUIREMENTS FOR OUTSIDE THE HIGH VELOCITY HURRICANE ZONES
2. NO ALLOWABLE STRESS INCREASE HAS BEEN USED IN THE DESIGN OF THE EZ-SCREENS.
3. ADEQUACY OF EXISTING STRUCTURE SHALL BE DETERMINED BY OTHERS.
4. UNIT HEIGHT (DISTANCE BETWEEN SUPPORTED SIDES) SHOWN IS MAXIMUM ALLOWABLE WITHOUT SITE-SPECIFIC ENGINEERING. LENGTH IS UNLIMITED.
5. SCREEN FABRIC SHALL BE MIN. 20-MIL. POLYPROPYLENE WOVEN USING 138 POLYESTER THREAD, TANABARA THREAD BY GORE WITH MIN. TENSILE BREAKING TEST STRENGTH OF 15 LBS.
6. WHERE GLAZING SEPARATION IS NOT REQUIRED OUTSIDE HVHZ EXCEPT FOR WIND ZONE 4 AND ALL WIND ZONES FOR ESSENTIAL FACILITIES. SEE DEFLECTION AND SCREEN SEPARATION REQUIREMENTS FOR THESE ZONES ON SHEET 1. SCREEN FABRIC SHALL HAVE POROSITY <= 10%.
7. MOUNTING BRACKET SHALL BE FASTENED TO SUBSTRATE ACCORDING TO EZ-SCREEN BRACKET TABLE AND FASTENER MANUFACTURER DIRECTIONS.
8. **MAX. ALLOWABLE DESIGN PRESSURES:**
+/- 60 PSF
9. SEE SHEET 3 FOR FABRIC SPECIFICATIONS.
10. THE PRODUCT SHALL BE LABELED IN ACCORDANCE WITH FBC - 1715.8

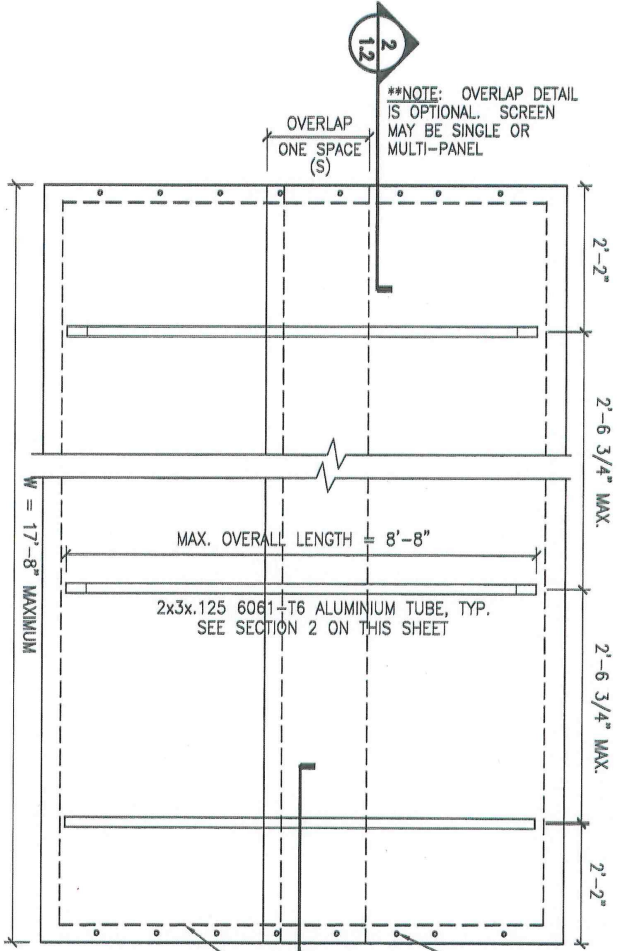

STORM-BAR ELEVATION

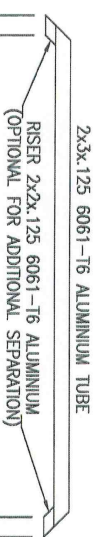

STORM-BAR RISER DIE (OPTIONAL)

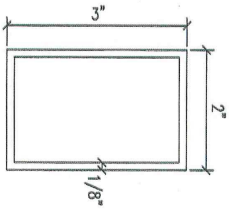

SCALE: 1" = 1"

ATTACHMENT OF TUBE TO ANGLE SHALL BE CONNECTED WITH (2) #8x1-1/2" PAN HEAD SELF DRILLING SCREWS
 ATTACHMENT OF ANGLE TO WOOD OR CONCRETE SHALL BE 1/2" Ø x 2-1/8" ANCHOR INSERT WITH (1) 1/4" Ø x 1-1/4" TRUSS HEAD MACHINE SCREW
 NOTE: CONTRACTOR SHALL BE RESPONSIBLE FOR ISOLATING DISSIMILAR METALS

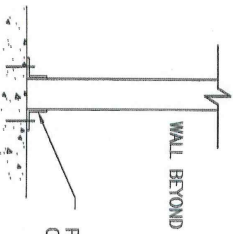

GROUND MOUNT DETAIL

SCALE: N.T.S.

STORM-BAR SIDE VIEW

SCALE: N.T.S.

ATTACHMENT OF TUBE TO RISER: SHALL BE CONNECTED WITH (2) #8x1-1/2" PAN HEAD SELF DRILLING SCREWS AND EPOXY
 ATTACHMENT OF TUBE OR RISER TO STRUCTURE: SHALL BE 1/2" Ø x 2-1/8" ANCHOR INSERT WITH (1) 1/4" Ø x 1-1/4" TRUSS HEAD MACHINE SCREW
 NOTE: CONTRACTOR SHALL BE RESPONSIBLE FOR ISOLATING DISSIMILAR METALS

STORM-BAR BAR DIE

SCALE: 1" = 1"

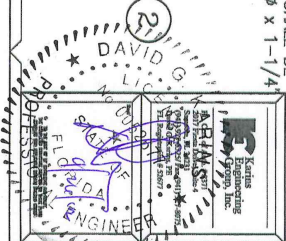
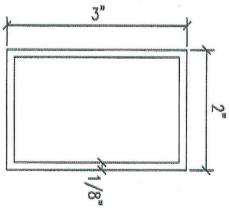

<p>Sheet Description:</p> <p>'EZ-SCREEN MAX' POLYPROPYLENE SCREEN HURRICANE SHUTTER WITH STORM BARS INSTALLATION INSTRUCTIONS</p>	<p>Project Name:</p> <p>CUSTOM HURRICANE PRODUCTS 2024 56TH AVE CIR E BRADENTON FL 34203 WWW.CUSTOMHURRICANERODUCTS.COM</p>
<p>DKK</p> <p>DATE: 06/CS-0397</p> <p>SCALE: VARIES</p> <p>DATE: 9/09/2010</p>	<p>Scale: 1.4</p>